



Detailed Instructions

DO-IT-YOURSELF

ARSENIC IN WATER TEST KIT

SCAN QR CODE TO WATCH THE HOW-TO VIDEO INSTRUCTIONS FOR THIS KIT



SafeHomeTestKits.com

Test Kit Contents

- A** Reaction Bottle with Mixing Cap
- B** Arsenic I Reagent Vial (Purple Cap)
- C** Arsenic II Reagent Vial (Green Cap)
- D** Arsenic III Reagent Vial (Red Cap)
- E** Test Cap
- F** Results Color Chart Card
- G** Fast-Track Instructions Card
- H** Detailed Instructions Sheet

Discard desiccant packets.

QUESTIONS?

If you have questions about the test process, or if you'd like to have additional testing[†] performed at our EPA-certified laboratory to find out exact values of Arsenic in your water, call 1-888-932-6699 or email customerservice@envirotestkits.com.

[†]EPA-certified laboratory testing is only available to customers living in the United States.

IMPORTANT SAFETY INSTRUCTIONS AND PRECAUTIONS

STORAGE AND HANDLING:

- Store test kit in a cool, dry, and dark place.
- Keep test kit components sealed until ready to use.
- Wearing protective gloves (like nitrile or latex) while conducting test is recommended but not required.
- Keep test kit components out of direct sunlight while conducting test.
- For best performance, view color results in natural daylight.
- Wash hands with soap and warm water before and after testing.

DANGER:

- Test pad contains Mercury compounds. Make sure you understand and follow all safety instructions before conducting test.
- Keep test kit away from fire. Mercury vapors and oxides generated during fires involving this product can be toxic.

WARNING:

- Keep test kit away from children and pets.
- Hydrogen and Arsine gas will be generated during the reaction process. Do not inhale gas. **Conduct test in a well-ventilated area.**
- Do not touch the test pad directly with your hands.
- Do not eat, drink, or smoke when using this product.

DISPOSAL:

- Dispose of used test components to comply with applicable regulations in your area. When the test is complete, you may discard the final solution in the reaction bottle by pouring it down a sink drain while the cold water tap is running. Flush drain with water for at least 5 minutes.

FIRST AID:

- IF INHALED: Blow nose and seek fresh air.
- IF ON SKIN: Remove contaminated clothing and wash the affected area with mild soap and water.
- IF IN EYES: Flush eyes with water for at least 15 minutes. Remove contact lenses if worn.
- IF INGESTED: Rinse mouth with water. Do not induce vomiting. Immediately seek medical attention.
- If irritation persists, seek medical attention.

DISCLAIMER:

- Test kit is for screening purposes only. Test results do not guarantee the level of safety of the water being tested. Environmental Laboratories, Inc., its subsidiaries and its associates disclaim any liability resulting from the use of this product, failure to follow instructions, or reliance on test results.

Testing Instructions

- ① Remove mixing cap from reaction bottle and fill reaction bottle to the 100 ml line with the freshwater sample to be tested.
- ② Completely empty contents from the **Arsenic I reagent vial (purple cap)** into the reaction bottle. Replace mixing cap and swirl bottle contents for **10 seconds**. If necessary, continue swirling until the reagent is completely dissolved before moving to the next step.
- ③ Remove mixing cap from reaction bottle. Completely empty contents (in the following order) from both the **Arsenic II reagent vial (green cap)** and **Arsenic III reagent vial (red cap)** into the reaction bottle. Replace mixing cap and swirl bottle contents for **exactly 10 seconds**. Immediately move to the next step.
NOTE: Reagents in this step are not required to be completely dissolved.
- ④ Quickly remove mixing cap from reaction bottle and screw **Test Cap** onto reaction bottle tightly.
NOTE: Do not allow the test pad inside the test cap to get wet, as this will cause the test to be invalid.
- ⑤ Allow reaction bottle to sit idle for 30 minutes* at room temperature. Keep bottle out of direct sunlight.
- ⑥ Remove test cap and compare the color of the test pad under the cap to the results color chart on the opposite side of the fast-track instructions card. Find the best color match and record the corresponding Arsenic concentration. This value is your test result.
NOTE: Black precipitate may form in the solution, inside the cap, or on the test pad during the reaction. This is normal and does not affect your result.

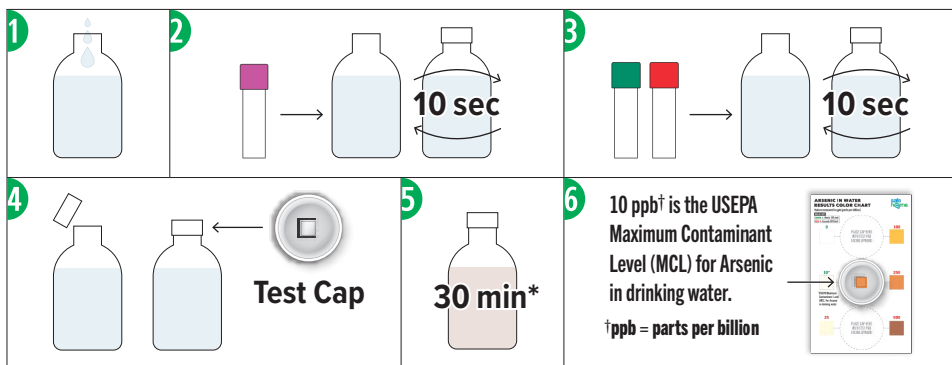

*TEST CONTROL: If the final color of the solution in the reaction bottle is any shade of clear, pink, or purple, your test was conducted successfully. →

IMPORTANT MESSAGE

No level of Arsenic in drinking water is considered safe to drink.

The USEPA 10 ppb federal drinking water standard for Arsenic is based on both its health effects and the cost of treatment by a public water supply for the reduction of Arsenic levels. **The USEPA health risk goal for Arsenic and other chemicals that can cause cancer is 0 ppb.** Health impacts of Arsenic may not occur right away and can develop after many years of low-level exposure.